

Pursuant to section 37(1)(d) and 76 of *The Planning and Development Act, 2007*, the RM of Edenwold No.158 Bylaw No. 2019-20 is conditionally APPROVED subject to Council preparing and adopting amendments to:

- c) Zone Block 1, Plan 66R03801 from Country Residential to a zoning district that recognizes the property is not suitable for residential development as the land was previously used as a landfill.

Within one year of the date of this decision.



Executive Director, Community Planning
Ministry of Government Relations

Date: May 1, 2020

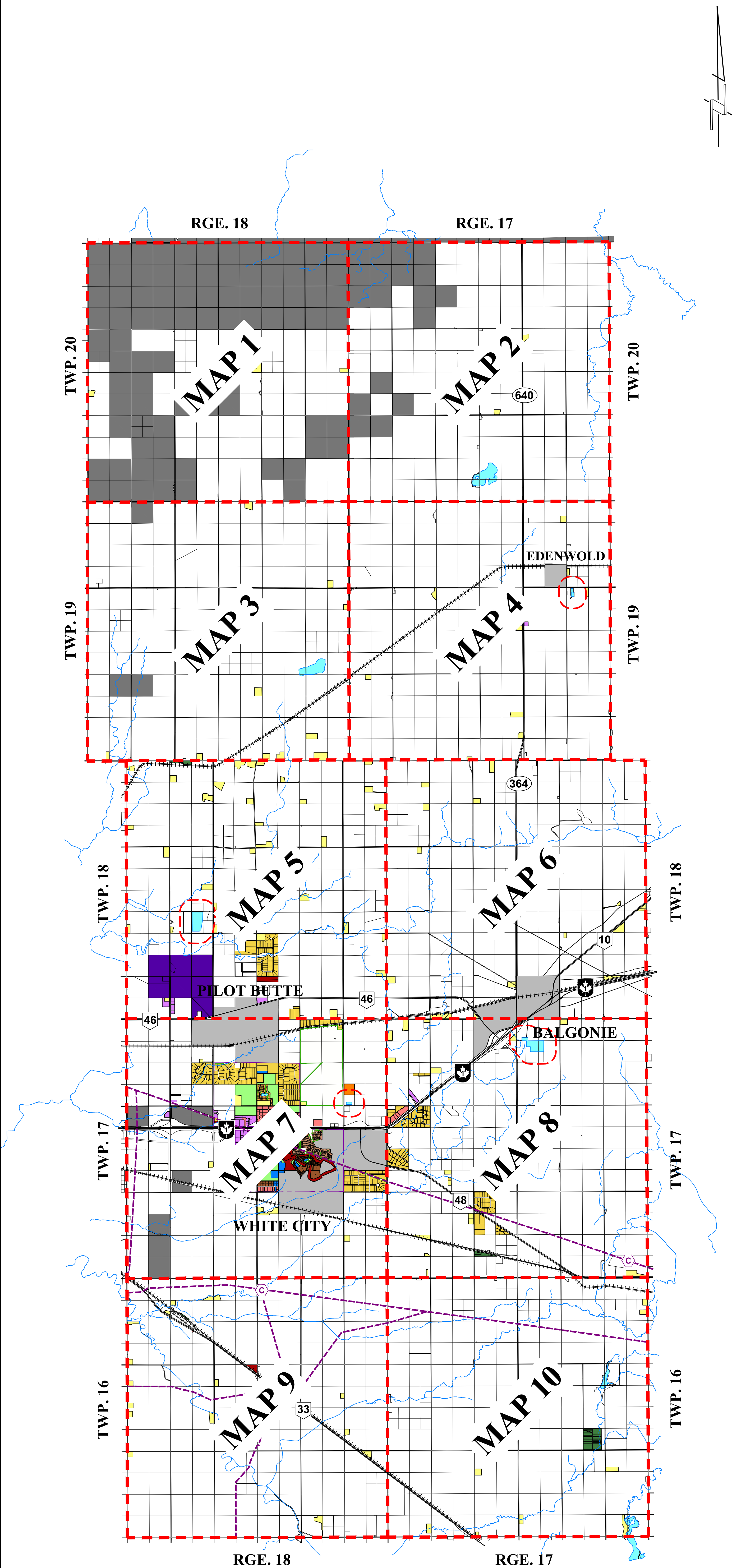

Rural Municipality of
Edenwold No. 158



This is the Zoning District Map referred to in Bylaw 2019-20
adopted by the Rural Municipality of Edenwold No. 158

Key Map

Saskatchewan
Date: December 10th, 2019

LEGEND:

- Contract Zone
- First Nation Reserves
- Highway
- Railway
- Urban Municipalities
- Watercourse
- Waterbody
- Recreation Area
- Buried Distribution Line
- Compressor Station
- Gas Cavern
- R.M. Boundary

ZONING DISTRICTS:

- Potentially Hazardous Lands
- AR - Agricultural Resource
- CR1 - Country Residential 1
- CR2 - Country Residential 2
- CR3 - Country Residential 3
- R1 - Urban Residential 1
- R2 - Urban Residential 2
- R3 - Urban Residential 3
- RMH - Residential Manufactured Home
- CS - Community Service
- SC - Shopping Centre
- HPC - High Profile Commercial
- COM1 - General Commercial
- IND1 - General Industrial
- EHI - Extraction & Heavy Industrial
- FD - Future Development
- DCD - Direct Control Districts:
 - DCD1 - Zehner
 - DCD2 - Richardson
 - DCD3 - Kathrinthal
 - DCD4 - Jameson

Reeve Mitchell Huber

Administrator Kim Mclvor

This map forms part of the RM of Edenwold's Zoning Bylaw, Bylaw 2019-20
Note: The information contained on this map is for reference only.

Scale - 1:75,000



Zoning Map 1

Saskatchewan

LEGEND:

- ZONING DISTRICTS:**

- 0 200 400 800 1200 1600 2000m
Scale - 1 : 20,000

Rural Municipality of Edenwold No. 158



This is the Zoning District Map referred to in Bylaw 2019-20 adopted by the Rural Municipality of Edenwold No. 158

Zoning Map 2

Twp. 20 - Rge. 17 - W.2Mer.

Saskatchewan

Date: Janusry 18th, 2021

LEGEND:

- Contract Zone
- First Nation Reserves
- Highway
- Railway
- Urban Municipalities
- Watercourse
- Waterbody
- Recreation Area
- Buried Distribution Line
- Compressor Station
- Gas Cavern
- R.M. Boundary

ZONING DISTRICTS:

- Potentially Hazardous Lands
- AR - Agricultural Resource
- CR1 - Country Residential 1
- CR2 - Country Residential 2
- CR3 - Country Residential 3
- R1 - Urban Residential 1
- R2 - Urban Residential 2
- R3 - Urban Residential 3
- RMH - Residential Manufactured Home
- CS - Community Service
- SC - Shopping Centre
- HPC - High Profile Commercial
- COM1 - General Commercial
- IND1 - General Industrial
- EHI - Extraction & Heavy Industrial
- FD - Future Development

Note: The information contained on this map is for reference only.

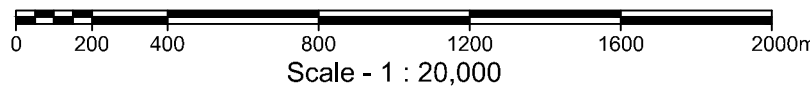

Initials: RH - PB
Client File:
Job No.: 209466
Drawing No.: 209466RM-R2

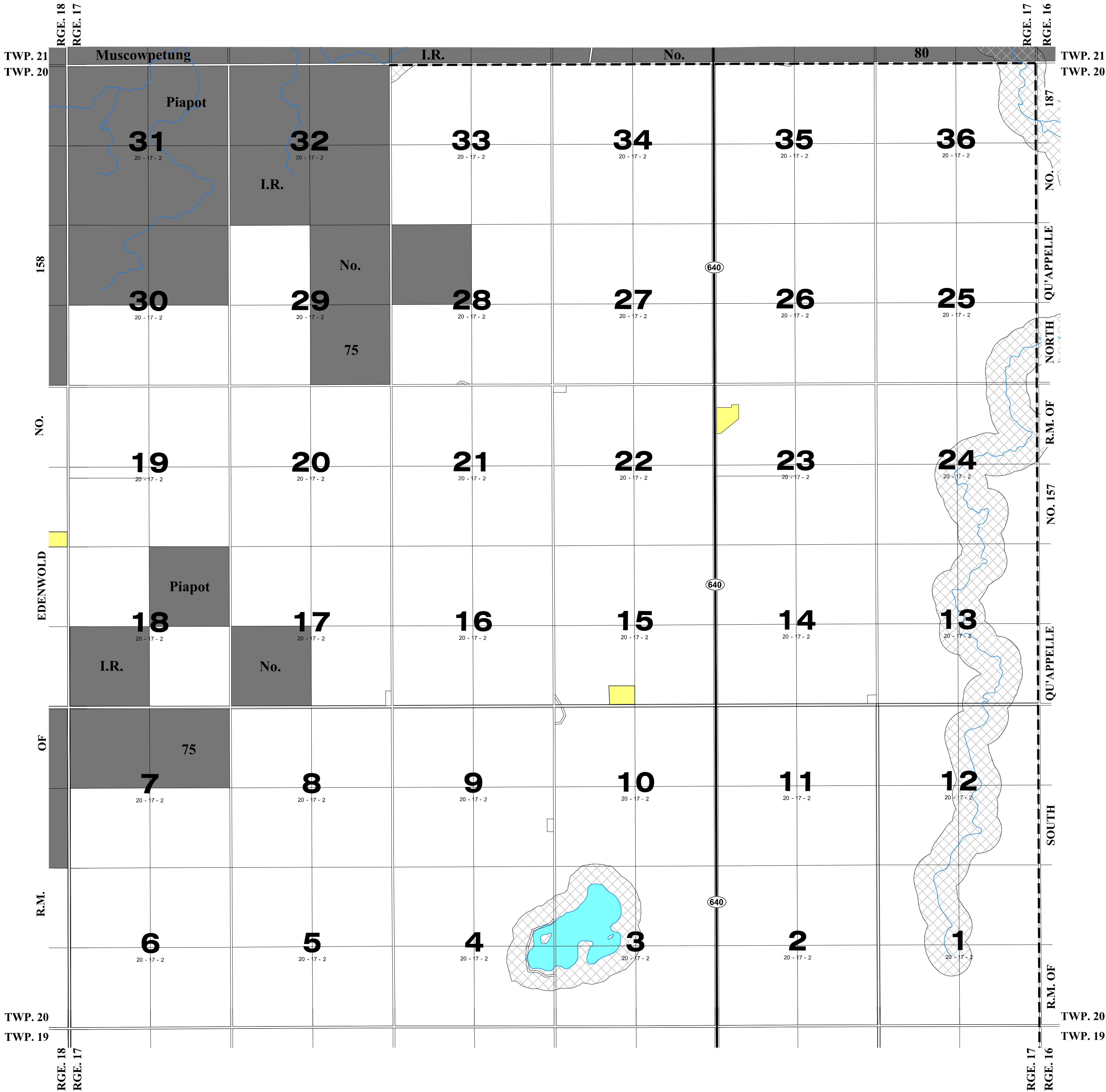



Zoning Map 3

Saskatchewan

LEGEND:

- ZONING DISTRICTS:**

- This map forms part of the RM of Edenwold's Zoning Bylaw, Bylaw 2019-20
Note: The information contained on this map is for reference only.

0 200 400 800 1200 1600 2000m
Scale - 1 : 20,000



Initials: RH - PB
Client File:
Job No. : 209466
Drawing No.: 209466RM-R1

Rural Municipality of Edenwold No. 158



This is the Zoning District Map referred to in Bylaw 2019-20 adopted by the Rural Municipality of Edenwold No. 158

Zoning Map 4

Twp. 19 - Rge. 17 - W.2Mer.

Saskatchewan

Date: January 18th, 2021

LEGEND:

- Contract Zone
- First Nation Reserves
- Highway
- Railway
- Urban Municipalities
- Watercourse
- Waterbody
- Recreation Area
- Buried Distribution Line
- Compressor Station
- Gas Cavern
- R.M. Boundary

ZONING DISTRICTS:

- Potentially Hazardous Lands
- AR - Agricultural Resource
- CR1 - Country Residential 1
- CR2 - Country Residential 2
- CR3 - Country Residential 3
- R1 - Urban Residential 1
- R2 - Urban Residential 2
- R3 - Urban Residential 3
- RMH - Residential Manufactured Home
- CS - Community Service
- SC - Shopping Centre
- HPC - High Profile Commercial
- COM1 - General Commercial
- IND1 - General Industrial
- EHI - Extraction & Heavy Industrial
- FD - Future Development

Note: The information contained on this map is for reference only.

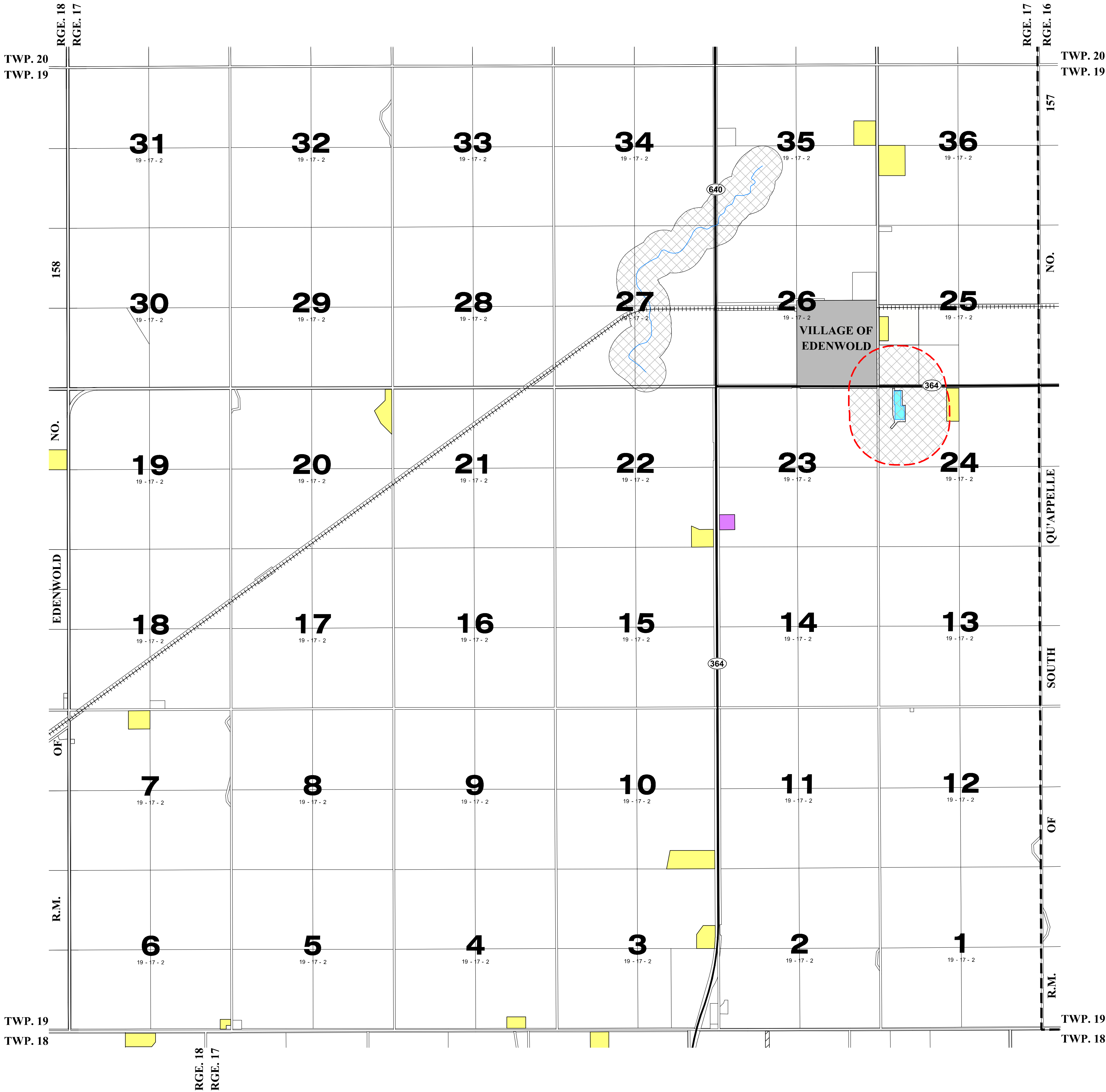
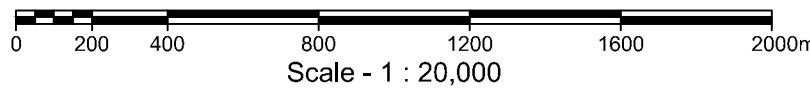

Rural Municipality of Edenwold No. 158



This is the Zoning District Map referred to in Bylaw 2019-20 adopted by the Rural Municipality of Edenwold No. 158

Zoning Map 5

Twp. 18 - Rge. 18 - W.2Mer.

Saskatchewan

Date: December 10th, 2019

LEGEND:

- Contract Zone
- First Nation Reserves
- Highway
- Railway
- Urban Municipalities
- Watercourse
- Waterbody
- Recreation Area
- Buried Distribution Line
- Compressor Station
- Gas Cavern
- R.M. Boundary

ZONING DISTRICTS:

- Potentially Hazardous Lands
- AR - Agricultural Resource
- CR1 - Country Residential 1
- CR2 - Country Residential 2
- CR3 - Country Residential 3
- R1 - Urban Residential 1
- R2 - Urban Residential 2
- R3 - Urban Residential 3
- RMH - Residential Manufactured Home
- CS - Community Service
- SC - Shopping Centre
- HPC - High Profile Commercial
- COM1 - General Commercial
- IND1 - General Industrial
- EH1 - Extraction & Heavy Industrial
- FD - Future Development
- Direct Control District 1 - Zehner

This map forms part of the RM of Edenwold's Zoning Bylaw, Bylaw 2019-20
Note: The information contained on this map is for reference only.

0 200 400 600 800 1000 1200 1400 1600 1800 2000m
Scale - 1 : 20,000



Initials: RH - PB
Client File:
Job No.: 209466
Drawing No.: 209466RM-R1

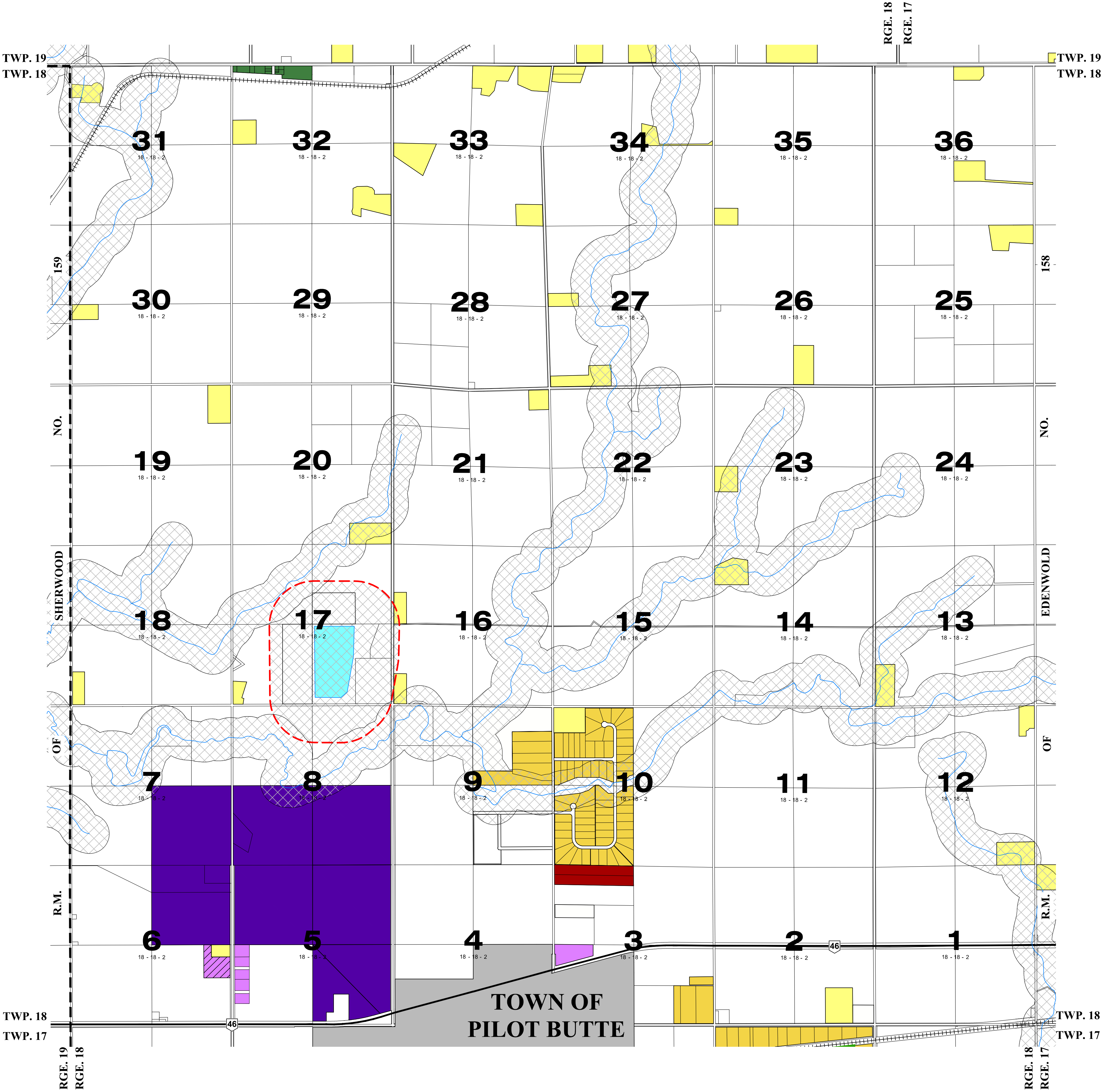

Rural Municipality of Edenwold No. 158



This is the Zoning District Map referred to in Bylaw 2019-20 adopted by the Rural Municipality of Edenwold No. 158

Zoning Map 6

Twp. 18 - Rge. 17 - W.2Mer.

Saskatchewan

Date: January 18th, 2021

LEGEND:

- Contract Zone
- First Nation Reserves
- Highway
- Railway
- Urban Municipalities
- Watercourse
- Waterbody
- Recreation Area
- Buried Distribution Line
- Compressor Station
- Gas Cavern
- R.M. Boundary

ZONING DISTRICTS:

- Potentially Hazardous Lands
- AR - Agricultural Resource
- CR1 - Country Residential 1
- CR2 - Country Residential 2
- CR3 - Country Residential 3
- R1 - Urban Residential 1
- R2 - Urban Residential 2
- R3 - Urban Residential 3
- RMH - Residential Manufactured Home
- CS - Community Service
- SC - Shopping Centre
- HPC - High Profile Commercial
- COM1 - General Commercial
- IND1 - General Industrial
- EHI - Extraction & Heavy Industrial
- FD - Future Development
- Direct Control District 1 - Zehner

Note: The information contained on this map is for reference only.

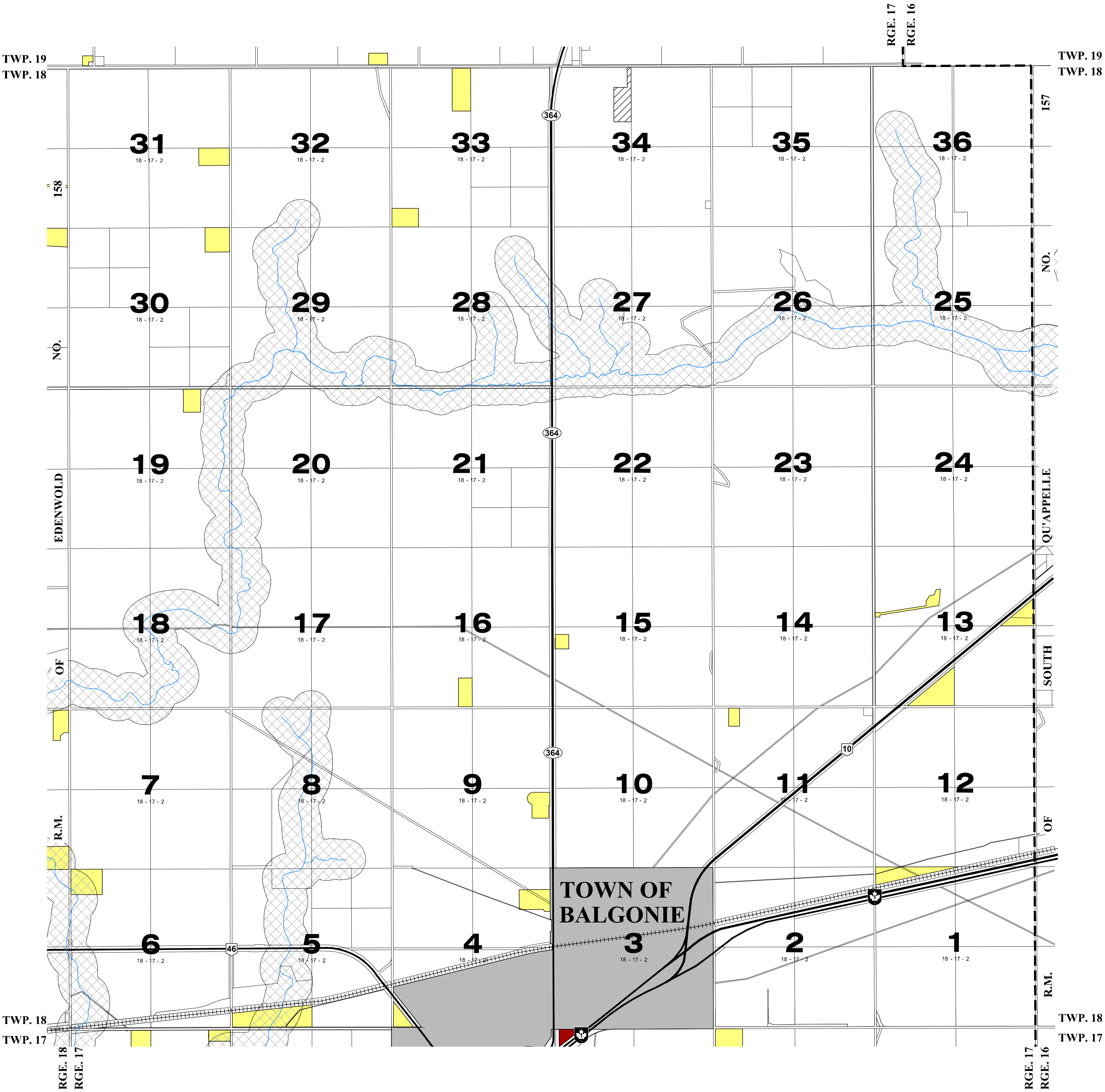
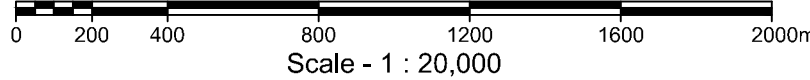

Rural Municipality of Edenwold No. 158



This is the Zoning District Map referred to in Bylaw 2019-20 adopted by the Rural Municipality of Edenwold No. 158

Zoning Map 7

Twp. 17 - Rge. 18 - W.2Mer.

Saskatchewan

Date: December 10th, 2019

LEGEND:

- Contract Zone
- First Nation Reserves
- Highway
- Railway
- Urban Municipalities
- Watercourse
- Waterbody
- Recreation Area
- Buried Distribution Line
- Compressor Station
- Gas Cavern
- R.M. Boundary

ZONING DISTRICTS:

- Potentially Hazardous Lands
- AR - Agricultural Resource
- CR1 - Country Residential 1
- CR2 - Country Residential 2
- CR3 - Country Residential 3
- R1 - Urban Residential 1
- R2 - Urban Residential 2
- R3 - Urban Residential 3
- RMH - Residential Manufactured Home
- CS - Community Service
- SC - Shopping Centre
- HPC - High Profile Commercial
- COM1 - General Commercial
- IND1 - General Industrial
- EHI - Extraction & Heavy Industrial
- FD - Future Development

This map forms part of the RM of Edenwold's Zoning Bylaw, Bylaw 2019-20

Note: The information contained on this map is for reference only.

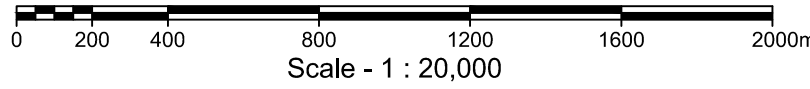

Initials: RH - PB
Client File:
Job No.: 209466
Drawing No.: 209466RM-R1

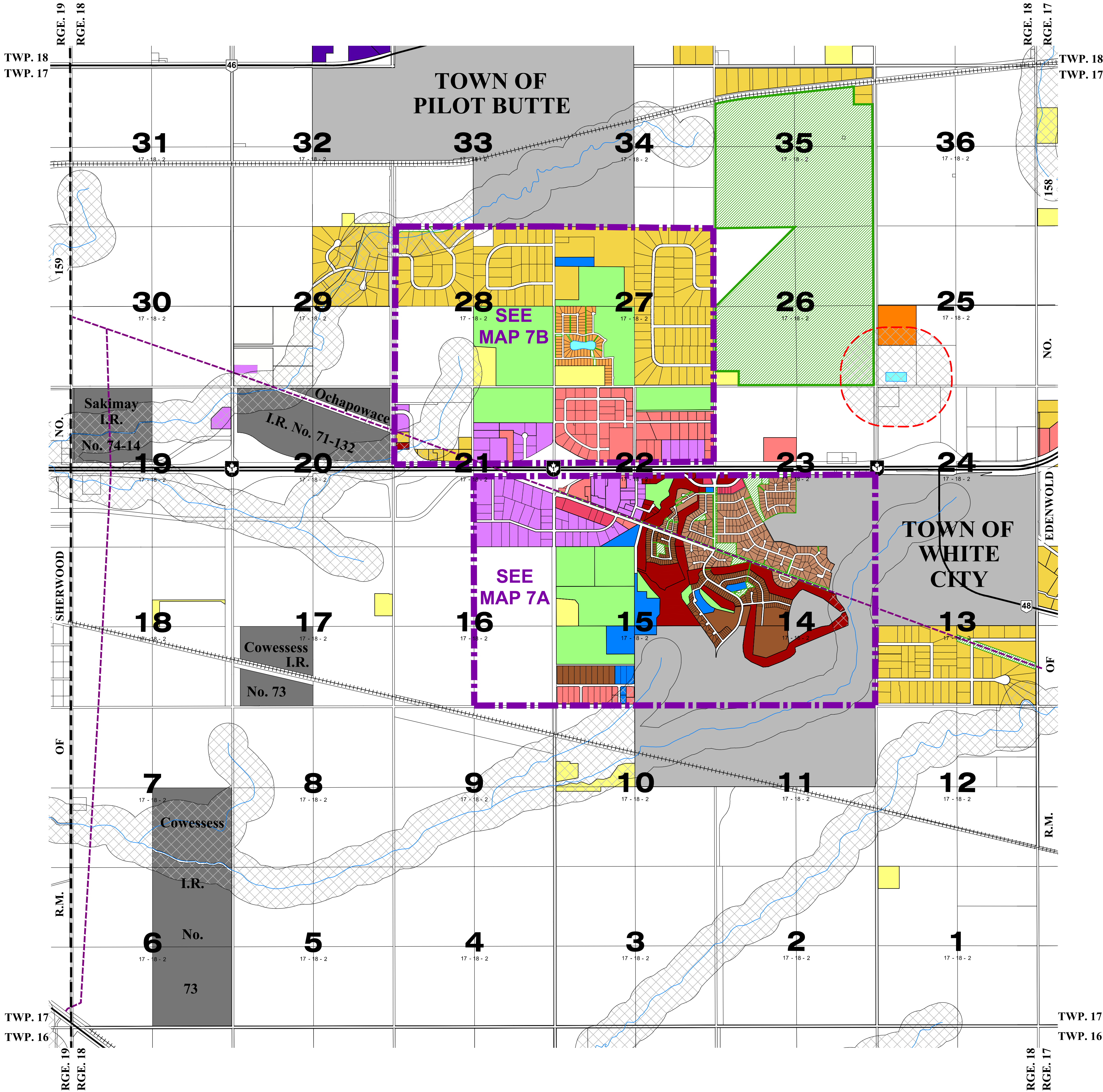









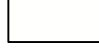
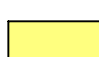
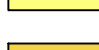



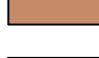

Zoning Map 7A

Saskatchewan

Date: January 18th, 2021

	Potentially Hazardous Lands
	AR - Agricultural Resource
	CR1 - Country Residential 1
	CR2 - Country Residential 2
	CR3 - Country Residential 3
	R1 - Urban Residential 1
	R2 - Urban Residential 2
	R3 - Urban Residential 3
	RMH - Residential Manufactured Home
	CS - Community Service
	SC - Shopping Centre
	HPC - High Profile Commercial
	COM1 - General Commercial
	IND1 - General Industrial
	EH1 - Extraction & Heavy Industrial
	FD - Future Development

	Contract Zone
	First Nation Reserves
	Highway
	Railway
	Urban Municipalities
	Watercourse
	Waterbody
	Recreation Area
	R.M. Boundary
	Buried Distribution Line

0 50 100 200 300 400 500m
Scale - 1 : 5,000

Altus Geomatics Limited Partnership

Initials: RH - PB
Patient File:
Job No. : 209466
Drawing No.: 209466RM-R2

Refer to Zoning Map 7 for the boundaries of this map

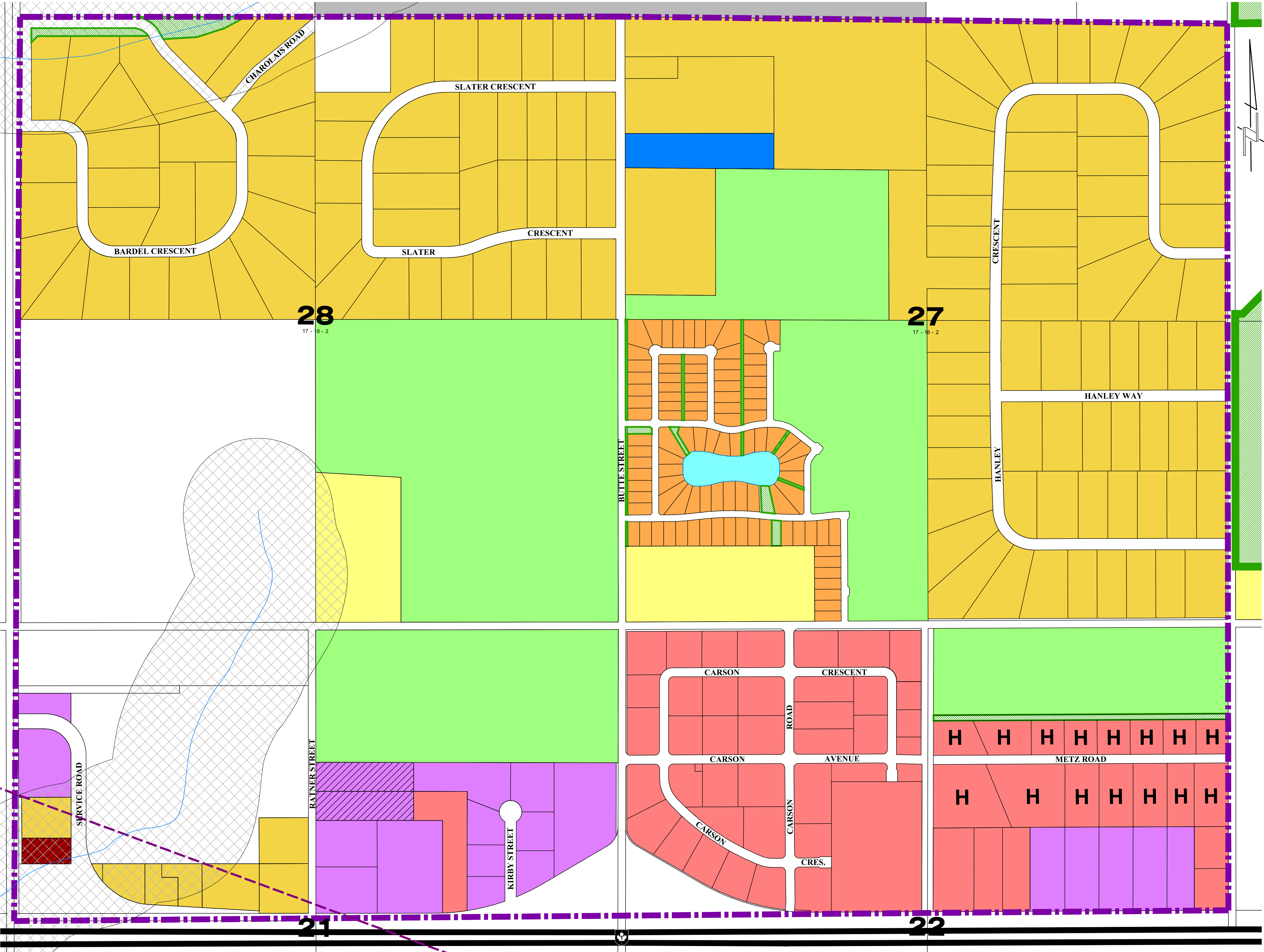

Rural Municipality of Edenwold No. 158



This is the Zoning District Map referred to in Bylaw 2019-20 adopted by the Rural Municipality of Edenwold No. 158

Zoning Map 7B

Twp. 17 - Rge. 18 - W.2Mer.

Saskatchewan

Date: January 18th, 2021

LEGEND:

- Contract Zone
- First Nation Reserves
- Highway
- Railway
- Urban Municipalities
- Watercourse
- Waterbody
- Recreation Area
- Buried Distribution Line
- Compressor Station
- Gas Cavern
- R.M. Boundary

ZONING DISTRICTS:

- Potentially Hazardous Lands
- AR - Agricultural Resource
- CR1 - Country Residential 1
- CR2 - Country Residential 2
- CR3 - Country Residential 3
- R1 - Urban Residential 1
- R2 - Urban Residential 2
- R3 - Urban Residential 3
- RMH - Residential Manufactured Home
- CS - Community Service
- SC - Shopping Centre
- HPC - High Profile Commercial
- COM1 - General Commercial
- IND1 - General Industrial
- EHI - Extraction & Heavy Industrial
- FD - Future Development

Note: The information contained on this map is for reference only.

0 50 100 200 300 400 500m
Scale - 1 : 5,000



Zoning Map 8

Saskatchewan

LEGEND:

- ZONING DISTRICTS:**

- Note: The information contained on this map is for reference only.

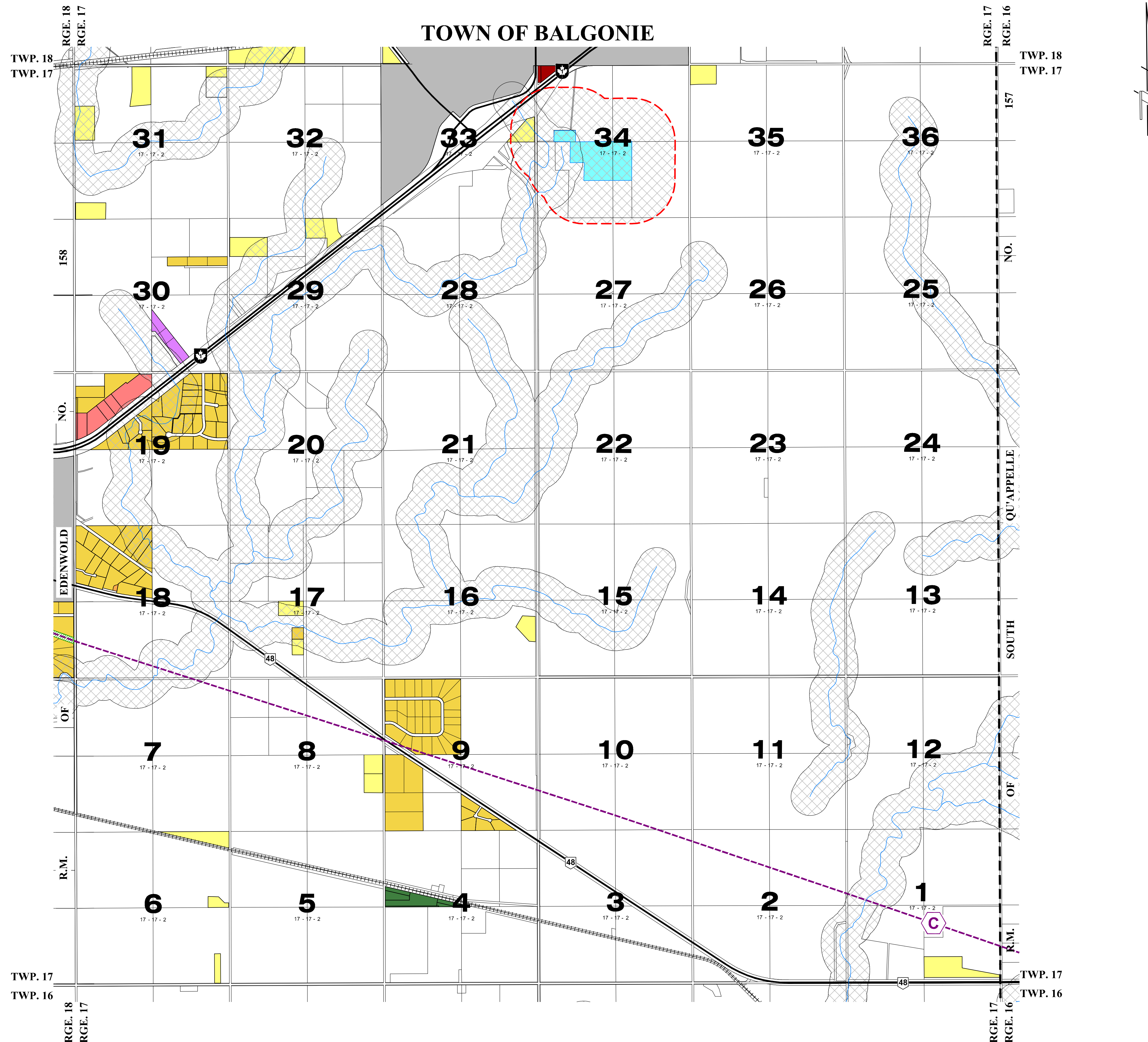
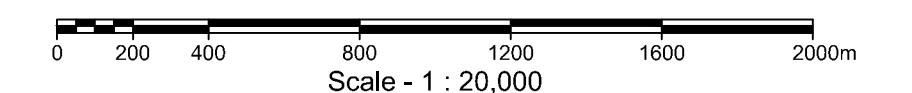



Zoning Map 9

Saskatchewan

LEGEND:

- ZONING DISTRICTS:**

- Note: The information contained on this map is for reference only.

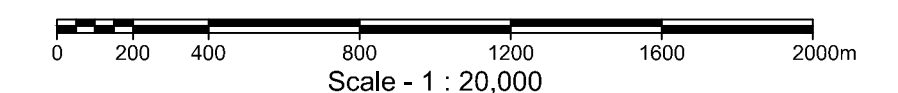

Rural Municipality of Edenwold No. 158



This is the Zoning District Map referred to in Bylaw 2019-20 adopted by the Rural Municipality of Edenwold No. 158

Zoning Map 10

Twp. 16 - Rge. 17 - W.2Mer.

Saskatchewan

Date: December 10th, 2019

LEGEND:

- Contract Zone
- First Nation Reserves
- Highway
- Railway
- Urban Municipalities
- Watercourse
- Waterbody
- Recreation Area
- Buried Distribution Line
- Compressor Station
- Gas Cavern
- R.M. Boundary

ZONING DISTRICTS:

- Potentially Hazardous Lands
- AR - Agricultural Resource
- CR1 - Country Residential 1
- CR2 - Country Residential 2
- CR3 - Country Residential 3
- R1 - Urban Residential 1
- R2 - Urban Residential 2
- R3 - Urban Residential 3
- RMH - Residential Manufactured Home
- CS - Community Service
- SC - Shopping Centre
- HPC - High Profile Commercial
- COM1 - General Commercial
- IND1 - General Industrial
- EHI - Extraction & Heavy Industrial
- FD - Future Development
- Direct Control District 3 - Kathrinthal

This map forms part of the RM of Edenwold's Zoning Bylaw, Bylaw 2019-20
Note: The information contained on this map is for reference only.

0 200 400 800 1200 1600 2000m
Scale - 1 : 20,000



Initials: RH - PB
Client File:
Job No.: 209466
Drawing No.: 209466RM-R1

